

# Location sketch of water wells in proximity to Bittering No. 4 and Bittering No. 1

12 water wells found with 1-mile of Bittering No. 4 in New York State  
 8 water wells found with 1-mile of Bittering No. 4 and Bittering No. 1 in Pennsylvania

**John Marowski (shown on TetraTech map)**  
 Per conversation with driller of record (Action Drilling Company of Cambridge Springs, PA) this well is located near "Lake Pleasant Road, Greene Twp." (Erie County, PA). It is not located in the State of New York.

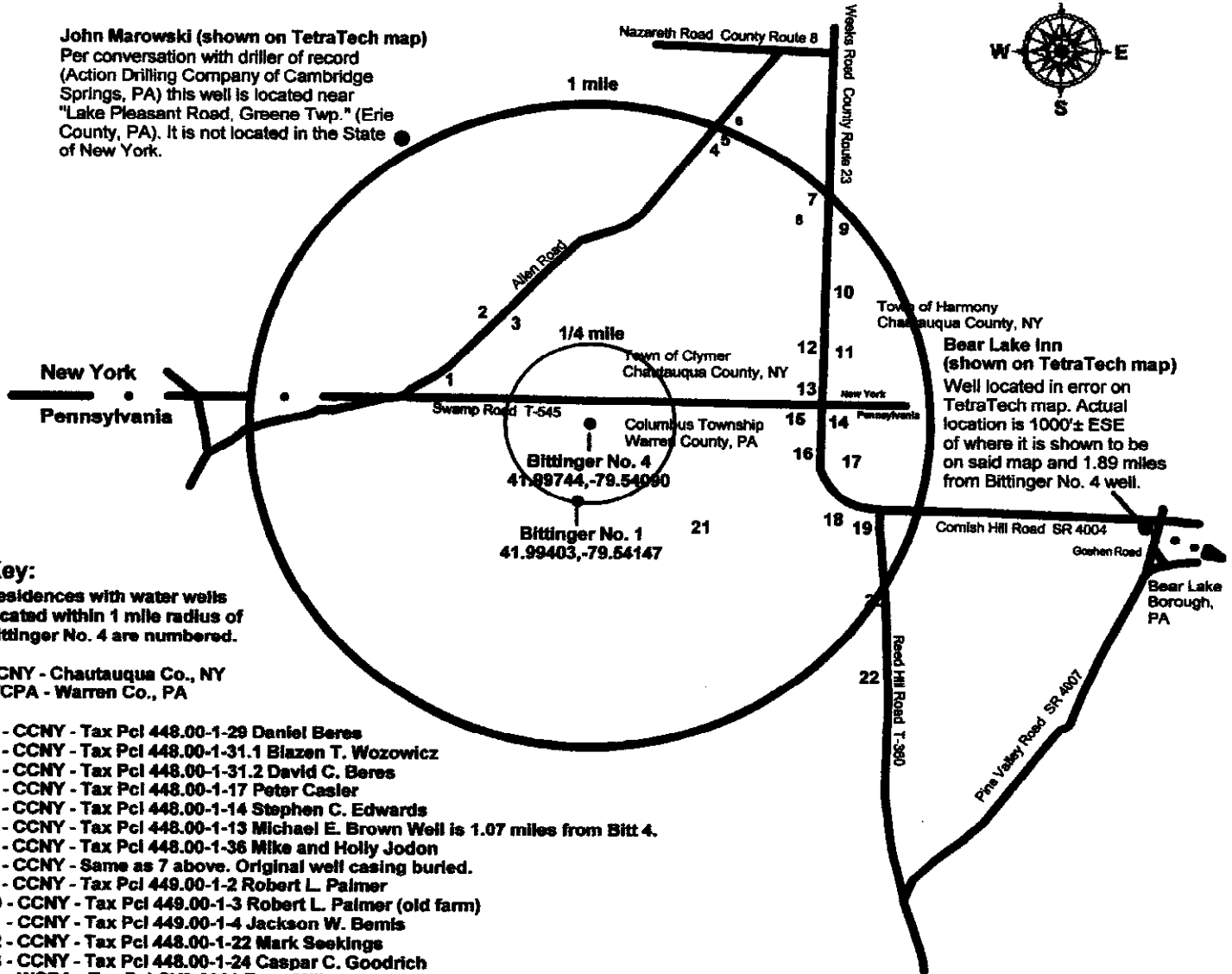
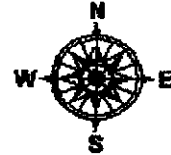

**Key:**  
 Residences with water wells located within 1 mile radius of Bittering No. 4 are numbered.

CCNY - Chautauqua Co., NY  
 WCPA - Warren Co., PA

- 1 - CCNY - Tax Pcl 448.00-1-29 Daniel Beres
- 2 - CCNY - Tax Pcl 448.00-1-31.1 Blazen T. Wozowicz
- 3 - CCNY - Tax Pcl 448.00-1-31.2 David C. Beres
- 4 - CCNY - Tax Pcl 448.00-1-17 Peter Casler
- 5 - CCNY - Tax Pcl 448.00-1-14 Stephen C. Edwards
- 6 - CCNY - Tax Pcl 448.00-1-13 Michael E. Brown Well is 1.07 miles from Bitt 4.
- 7 - CCNY - Tax Pcl 448.00-1-36 Mike and Holly Jodon
- 8 - CCNY - Same as 7 above. Original well casing buried.
- 9 - CCNY - Tax Pcl 449.00-1-2 Robert L. Palmer
- 10 - CCNY - Tax Pcl 449.00-1-3 Robert L. Palmer (old farm)
- 11 - CCNY - Tax Pcl 449.00-1-4 Jackson W. Bemis
- 12 - CCNY - Tax Pcl 448.00-1-22 Mark Seekings
- 13 - CCNY - Tax Pcl 448.00-1-24 Caspar C. Goodrich
- 14 - WCPA - Tax Pcl CY3-2361 Enos Miller
- 15 - WCPA - Tax Pcl CY3-2341 Bear Lake Properties (f. Singh see DCNR well record)
- 16 - WCPA - Tax Pcl CY3-2382 Theodore Smith Well depth: 250' ±
- 17 - WCPA - Tax Pcl CY3-3147 Ronald Craker
- 18 - WCPA - Tax Pcl CY3-31752 Chuck Williams
- 19 - WCPA - Tax Pcl CY3-31753 Jeff McCray
- 20 - WCPA - Tax Pcl CY3-2633 John Wright Well is 1.01 m from Bitt 4 and 0.93 m from Bitt 1.
- 21 - WCPA - Tax Pcl CY3-2362 Jack McCoy Well depth: 155' ±
- 22 - WCPA - Tax Pcl CY3-2661 Thomas Reed (total 3 wells near house - 1.17 m ± to Bitt No. 4)

**Bear Lake Inn (shown on TetraTech map)**  
 Well located in error on TetraTech map. Actual location is 1000'± ESE of where it is shown to be on said map and 1.89 miles from Bittering No. 4 well.

Map traced from a map prepared by: TetraTech on 10/28/2010. Wells located using handheld GPS unit and from aerial photographs. Data provided by local residents and owners of water wells. See original TetraTech map for scale. Coordinates will be supplied on request.

● Bull Michael (shown on TetraTech map)

Bill Peiffer July 2, 2011